



Wireless Mini Trackball Keyboard



Model: WKB-3000UB



QuickGuide English

①

LIMITED WARRANTY

ADESSO provides one year limited warranty for the quality of all its products in materials and workmanship.

During this period, ADESSO will repair or replace all merchandise, which proved to be defective. However, ADESSO will not warranty any product which has been subjected to improper freight Handling, shipping abuse, neglect or unauthorized repair or installation. The warranty also will not cover products installed with Non-ADESSO components and product with broken sealed and assembly trace. After replacement of RMA, ADESSO reserves the right to request the total cost of the replacement products with broken seals or assembly trace.

If you discover a defect, Adesso will, at its option, repair or replace the product at no charge to you, provided you return it during the warranty period with transportation charges pre-paid to Adesso. You must contact Adesso at support@adesso.com for a Return Merchandise Authorization number (RMA) prior to returning any product. For each product returned for warranty service, please include your name, shipping address (no P.O. Box), telephone number, copy of the bill of sale as proof of purchase and have the package clearly marked with your RMA number.

SUPPORT

We have listed most of our FAQ's (Frequently Asked Questions) at: <http://www.adesso.com/faqs.asp>. Please visit our FAQ Service & Support pages before you contact our E-mail or Telephone Support.

Email Support: If our FAQ's do not help you resolve your issues, please email support@adesso.com

Telephone Support:
Toll Free: (800) 795-6788
9:00AM to 5:00PM PST Monday - Friday

②

INTRODUCTION

Enjoy the freedom of wireless connectivity with Adesso's wireless mini Keyboard with Optical trackball. 2.4 GHz wireless radio frequency technology with 6500 IDs on 12 channels allows users to work freely with no space constraints. In addition, the optical trackball provides great accuracy with minimal hand movement due to its 800 dpi resolution. The lightweight and stylish keyboard offers mobility and comfort wherever you type. Take complete control of your desktop with hotkeys. The different hotkeys give you quick access to some of your most common tasks such as e-mail access, volume control, and launching your web browser - at the push of a button.

FEATURES

- 2.4 GHz RF Wireless Technology.
- Built-in Trackball which eliminates use of a mouse.
- 360-degree navigation, sleek and elegant design.
- Fully functional as a standard full-size regular keyboard.

REQUIREMENTS

- Hardware: IBM, Pentium II class compatible or higher
- Operating System: Windows 7, Vista, XP, 2000 and below
- Connection: USB

③

INSTALLATION

- Place batteries.
 - Open the battery cover under the keyboard and place 4 AA batteries inside the battery compartment
 - Close the battery cover.



④

- Plug the Wireless Receiver of the keyboard into the USB ports of your computer.

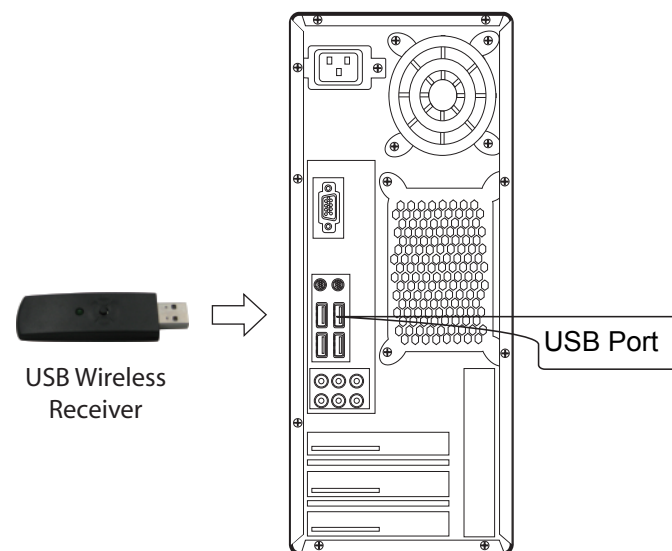

⑤

- Turn on your computer.

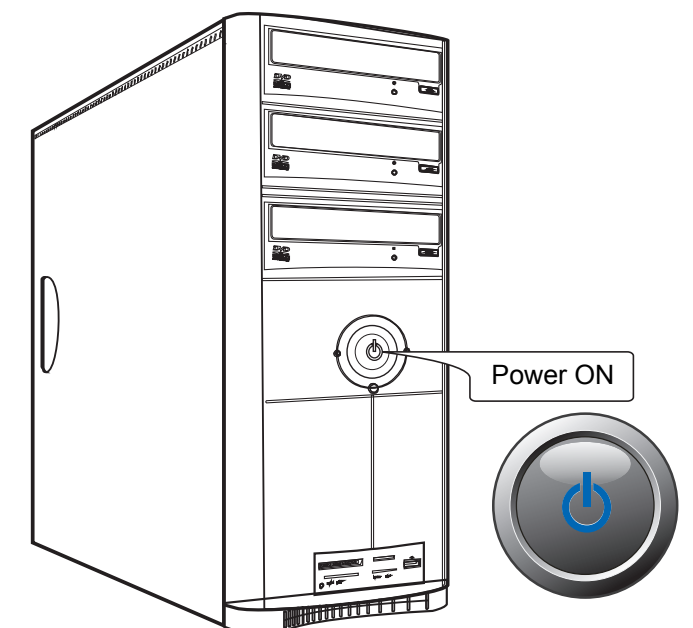

⑥

- Synchronize the ID of the receiver and the keyboard:
 - Press ID button on Dongle receiver, the Green LED will flash which means the ID is searching.

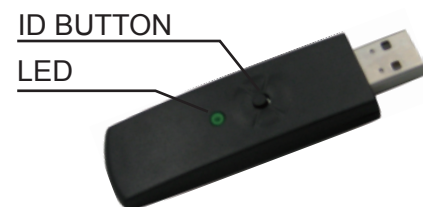

- Press the ID button on the BACK of the keyboard. After you press the ID button on the BACK of keyboard, the green LED light will turn off on the dongle receiver which means the connection was successful.



⑦

HOTKEYS DESCRIPTION

Scroll Wheel
Offers the same functions as the scroll wheel on a mouse allowing you to scroll up and down

Mouse Left Button
Direct access to left click options

Internet Hot Keys
Back, Forward, www, E-mail, My computer

Multimedia Hot Keys
Change tracks, stop, play/pause, mute change volume

Battery Low Indicator

Optical Trackball

Mouse Left Button
Mouse Right Button



⑧

NOTICE:

- RF Signal LED on the receiver will flash when the keyboard is being used.
- When Low Battery Indicator LED lights on, it means the keyboard requires a change of batteries.

TROUBLESHOOTING

If you cannot get your keyboard to work after installation, please try the following:

- Make sure you have connected the receiver correctly to the computer. The receiver has been properly plugged onto computer's USB ports.
- Make sure you have inserted four AA batteries inside the battery compartment correctly.
- Move the keyboard closer to the receiver.
- If using more than two units and interfere occurred, please reset ID again.

⑨